

€389,000

SLV137

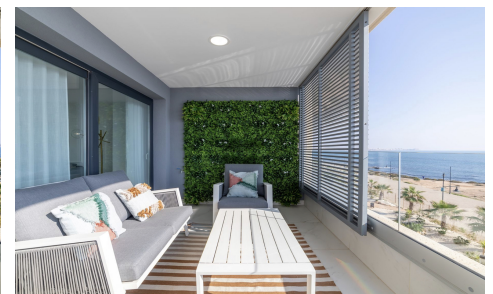

Apartment in Torrevieja



3



2



N/A



N/A



New Build, a seafront apartment development in Punta Prima, Torrevieja, with spectacular views over the sea and the beach. The residential development offers 2 and 3 bedroom apartments with 2 bathrooms. All apartments in the first phase are south facing and have good sized terraces and magnificent views over the Mediterranean Sea. The apartments have been designed for comfort and convenience, with excellent qualities and a layout that allows maximum enjoyment of the communal areas of the development. All units are delivered with an underground parking space and storeroom. Panorama Mar is a private gated community with closed circuit surveillance. The development stands out for its ample landscaped areas and complete installations, from which... (Ask for More Details)